

BLANCO SUBLINE 800-U

Silgranit volcano-grey

Product code 23703**Product description**

A stylish and timeless sink model that fits both modern and traditional kitchens. The depth of the sink (190 mm) and the small corner rounding make the sink practical and easy to keep clean. The material is the unique, almost scratch-resistant SILGRANIT stone mass developed by Blanco, which is heat-resistant, retains its color and is easy to clean. The patent-protected SILGRANIT material combines ease of care, practicality and durability.

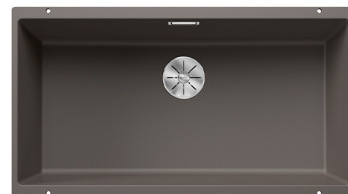

INFINO

Technical information

- Sink cabin min. length: 90 cm
- Allasmateriaali: kivikomposiitti
- Sink installation method: Bottom mounted
- Sink color: Silgranit volcano grey
- Waste: 3,5" basket strainer InFino no pop-up
- Depth of main sink: 220 mm

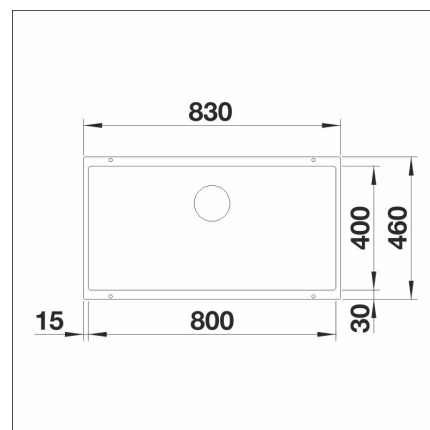
**Delivery content**

- BLANCO Silgranit sink
- bottom valve system
- domestic Prevx Smartloc water trap

**Downloads**

- Assembling instruction
- Prevx Smartloc instructions
- Service manual
- Material information
- Cutout dimensions
- Vaatimustenmukaisuusvakuutus
- InFino waste

Recommended accessories**InFino set**[Read more >>](#)**Cutting board**[Read more >>](#)**Cutting board**[Read more >>](#)**Pop up set InFino**[Read more >>](#)**Pop up set InFino**[Read more >>](#)