

BLANCO ETAGON 500-U

Silgranit jasmin

Product code 110205

Product description

Blanco Etagon is a beautifully shaped high quality stainless steel sink with a modern overall appearance. It has a highly innovative system concept of rails, that create three different working levels to the sink. There are two pieces of rails that can be placed side by side or on top of each other, either to the middle tier of the sink, or to the table top level. Rails work well with chopping board, holding kettles and dishes in different levels, making everyday kitchen tasks enjoyable. When not in use, rails can hold brush and cloth.

High-quality features with...

Technical information

- Sink cabin minimum length: 60 cm
- Material: kivikomposiitti
- Sink installation method: Bottom mounted
- Waste: 3,5" basket strainer InFino no pop-up
- Depth of main sink: 200 mm

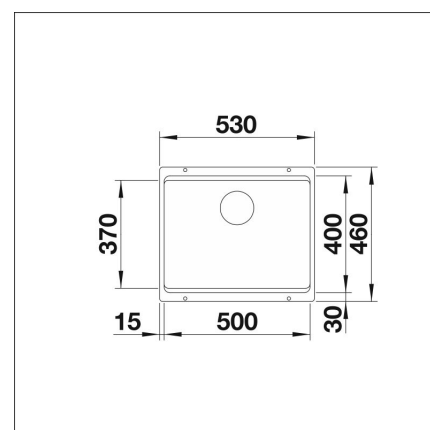

Delivery content



Downloads

- Prevox Smartloc instructions
- Assembling instruction
- Huolto- ja hoito-ohje
- Material information
- Cutout dimensions
- InFino waste
- InFino video

Recommended accessories



BLANCO DeepClean

[Read more >>](#)



Blanco DailyClean+

[Read more >>](#)



InFino set

[Read more >>](#)



Colander

[Read more >>](#)



Cutting board

[Read more >>](#)