

BLANCO ETAGON 500-U

Silgranit coffee

Product code 110204

Product description

Blanco Etagon is a beautifully shaped high quality stainless steel sink with a modern overall appearance. It has a highly innovative system concept of rails, that create three different working levels to the sink. There are two pieces of rails that can be placed side by side or on top of each other, either to the middle tier of the sink, or to the table top level. Rails work well with chopping board, holding kettles and dishes in different levels, making everyday kitchen tasks enjoyable. When not in use, rails can hold brush and cloth.

High-quality features with...

Technical information

- Sink cabin min. length: 60 cm
- Sink installation method: Bottom mounted
- Material: Silgranit (komposiitti)
- Waste: 3,5" basket strainer InFino no pop-up
- Depth of main sink: 200 mm

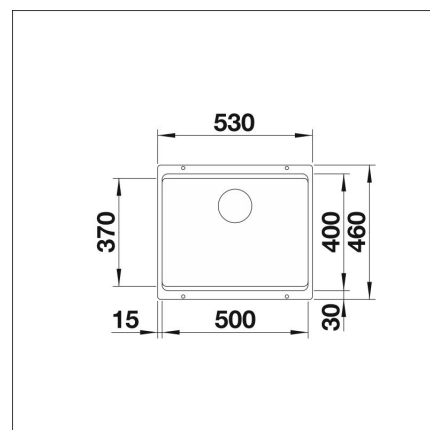
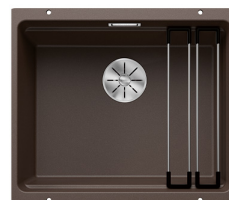

Delivery content



Downloads

- Assembling instruction
- Prevox Smartloc instructions
- Service manual
- Material information
- Cutout dimensions
- InFino waste

Recommended accessories



Cutting board
[Read more >>](#)



Pop up set InFino
[Read more >>](#)



ETAGON 500-U
[Read more >>](#)



ETAGON 500-U
[Read more >>](#)



Colander
[Read more >>](#)