

BLANCO VINTERA XL 9

Silgranit rock grey

Product code 10211

Product description

Classic design combined with modern SILGRANIT material make the BLANCO VINTERA XL 9 sink an eye-catcher in the kitchen. The design of the sink is reminiscent of a classic and traditional farmhouse sink, but the features of the sink have been brought to the present day. The material is the unique, almost scratch-resistant SILGRANIT stone mass developed by Blanco, which is heat-resistant, retains its color and is easy to clean. The patent-protected SILGRANIT material combines ease of care, practicality and durability.



INFINO

Technical information

- Sink cabin min. length: 90 cm
- Allasmateriaali: kivikomposiitti
- Sink installation method: Bottom mounted
- Sink color: Silgranit rock grey
- Waste: 3,5" basket strainer InFino no pop-up
- Depth of main sink: 220 mm

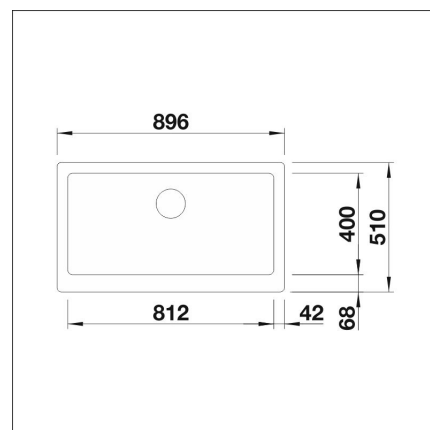

Delivery content

- BLANCO Silgranit sink
- bottom valve system
- domestic Prevx Smartloc water trap



Downloads

- Assembling instruction
- Prevx Smartloc instructions
- Service manual
- Material information
- Cutout dimensions
- Vaatimustenmukaisuusvakuutus
- InFino waste

Recommended accessories



Foldable Grid
[Read more >>](#)



LAPETEK LINO-A
[Read more >>](#)